

# Please Observe the 10km/h Speed Limit At All Times

## General Information

Off street parking is available in the underground car park underneath the Number 2 Oval Sports Complex during School days, Saturday sport and other times when events are being held at the School. The entrance to the car park is off Victoria Street, near the intersection with Holwood Avenue.

For Saturday sport and major School events, off-street parking is also available in the underground car park underneath Number 3 Oval. The entrance to this car park is also off Victoria Street but near the intersection with Harland Street.

## Picking Up and Dropping Off Students

Normal drop off and pick up principles apply:

- Parents must use the designated zone (see map)
- Drivers remain in the vehicle
- Students must have their bags and other belongings with them in the passenger seat and are not permitted to go to the boot of the vehicle. The boot may be accessed by an assisting adult
- Students must enter and exit the vehicle on the curb side and are not permitted to walk between motor vehicles at any time.

## Parking Guidelines During School Days

All Trinity students using the car park will park in the GREEN ZONE. Students must first have written permission from the Master of the Senior School and display their parking pass at all times.

Parents and visitors who are not engaged in picking up or dropping off students may park in either the YELLOW or PURPLE ZONE.

The BLUE ZONE is reserved for School use.

## Emergency Contacts

For all emergencies, please contact the Second Master of the Summer Hill Campus on **0420 920 211** or the After Hours Security Guard on **0431 419 828**.



Entrance to car park off Victoria Street



Car park entrance and exit

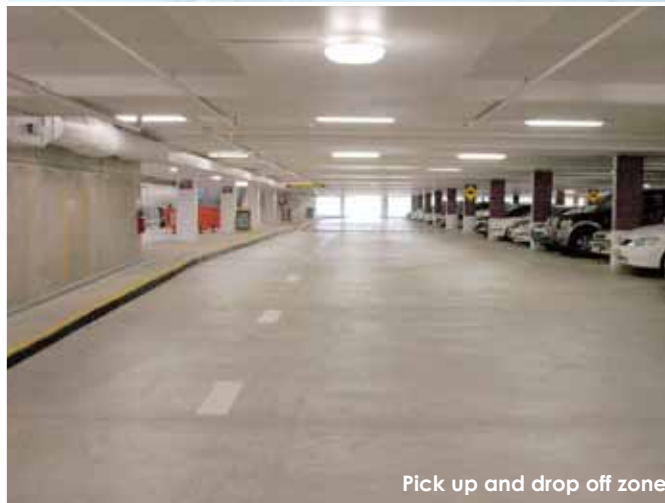

Pick up and drop off zone



TRINITY GRAMMAR SCHOOL

Number 2 Oval  
Underground Car Park Facility  
Guidelines for Drivers



VICTORIA STREET

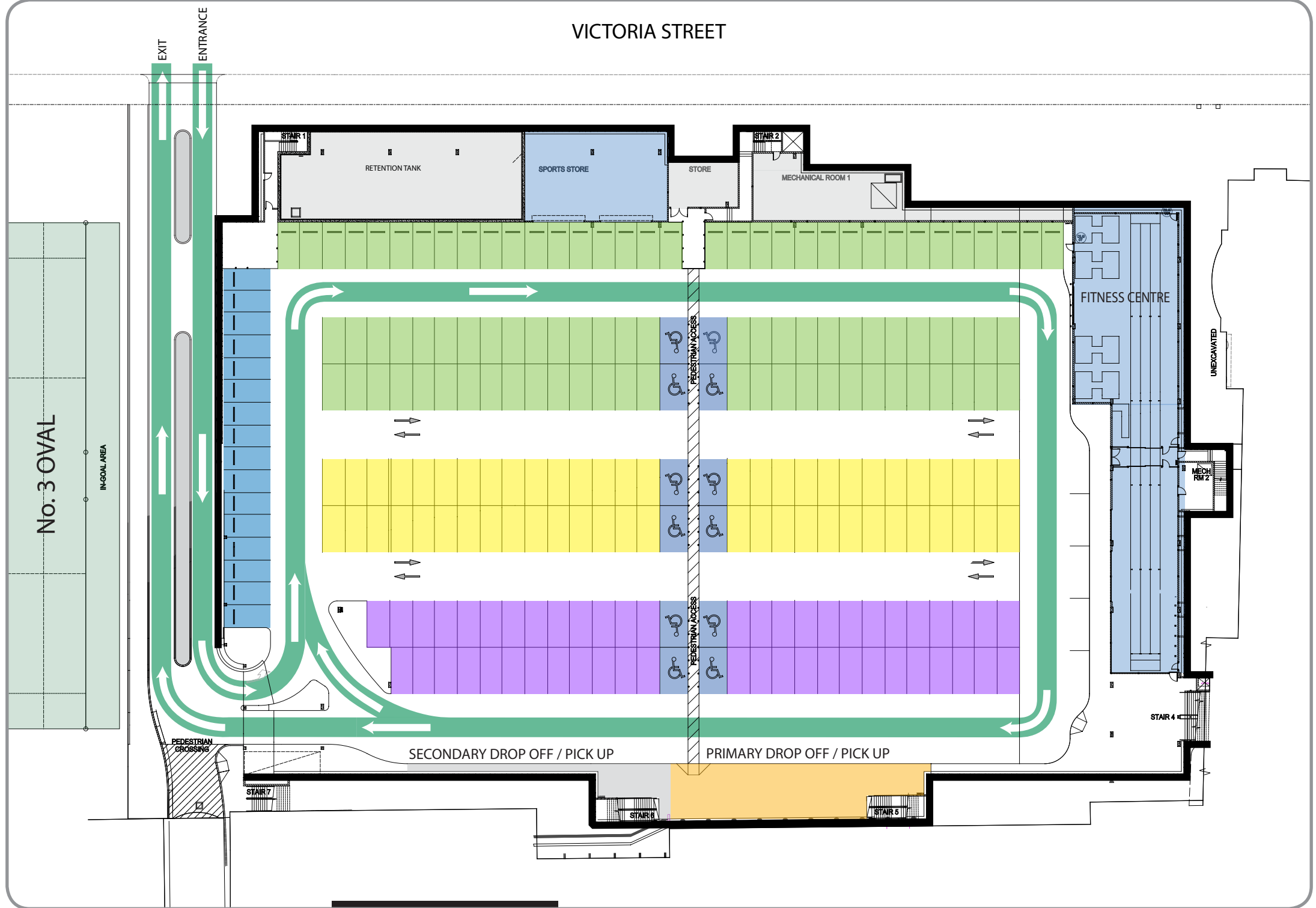

No. 3 OVAL

INGOAL AREA

EXIT

ENTRANCE

STAIR 1

RETENTION TANK

SPORTS STORE

STORE

STAIR 2

MECHANICAL ROOM 1

FITNESS CENTRE

UNEXCAVATED

MECH. RM 2

STAIR 4

PEDESTRIAN CROSSING

STAIR 7

STAIR 8

STAIR 5

SECONDARY DROP OFF / PICK UP

PRIMARY DROP OFF / PICK UP

PEDESTRIAN ACCESS

PEDESTRIAN ACCESS